

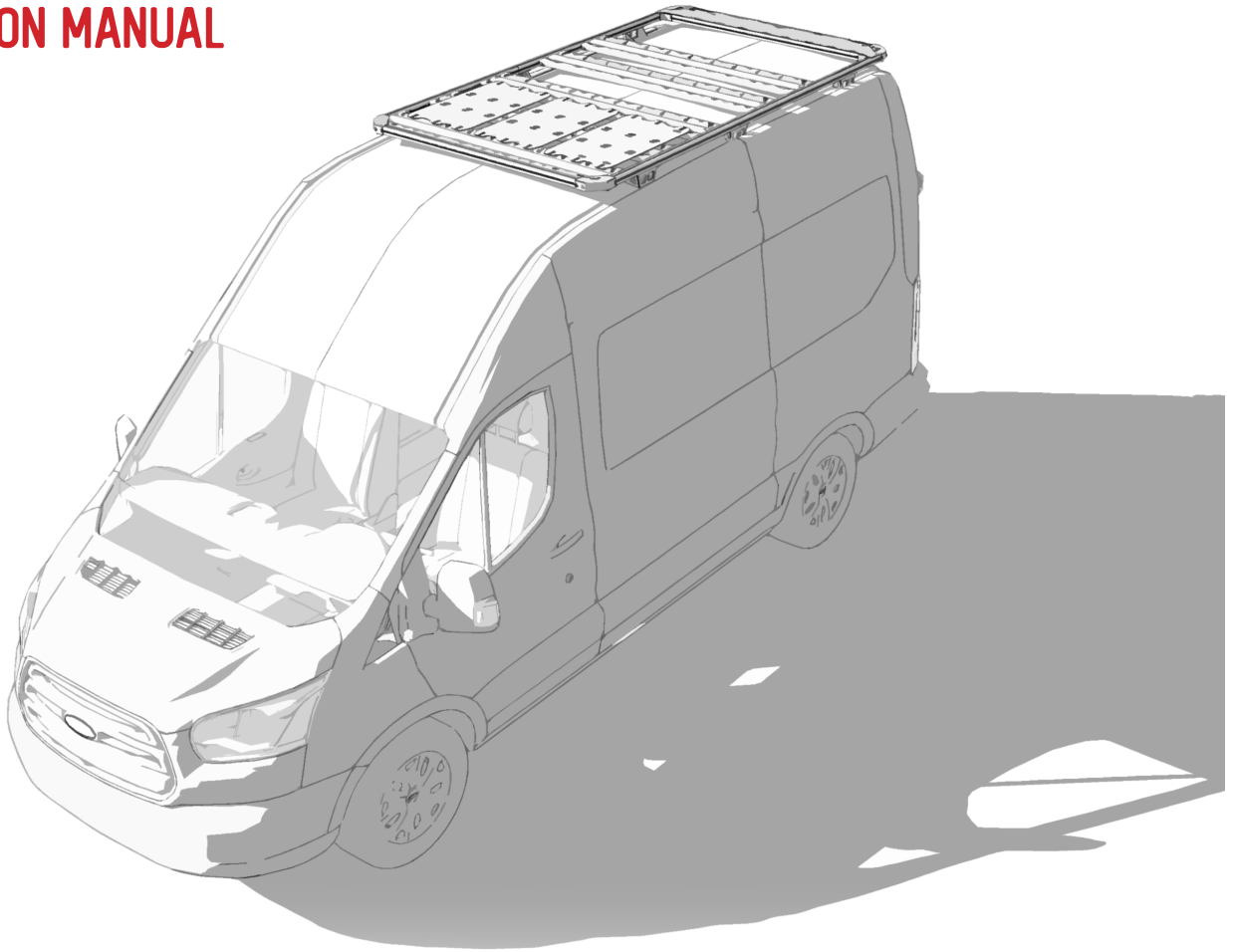

## **ROOFTOP DECK - RISER KIT FOR TRANSIT VANS**

### **INSTRUCTION MANUAL**



Thank you for purchasing the Van Cafe Rooftop Deck Riser Kit for the Transit van.

Created in Fort Collins, Colorado, the Van Cafe Rooftop Deck is the product of years of manufacturing expertise. Here at Van Cafe, we are innovators, thinkers, creators, doers and, most importantly, users! We love the outdoors and the idea of sharing experiences and memories with our families, friends, and our customers.

As always, please reach out to us at [support@vancafe.com](mailto:support@vancafe.com) with any questions.

# CONTENTS

Unboxing & Required Tools .....	3-5
Transit Van Fitment .....	6
Installation Step - 1 .....	7-8
Installation Step - 2 .....	9
Installation Step - 3 .....	10
Installation Step - 4 .....	11
Installation Step - 5 .....	12
Finished .....	13

## TRANSIT PRODUCT & COMPONENT LINKS

[Rooftop Deck: Base Perimeter Rack](#)

[Rooftop Deck: Plank Kit](#)

[Rooftop Deck: Deck Board Kit](#)

[Rooftop Deck: Filler Panel Kit](#)

[Rooftop Deck: Side Ladder](#)



## ROOFTOP DECK - RISER KIT FOR TRANSIT VANS

Installation questions? Email [support@vancafe.com](mailto:support@vancafe.com)



# UNBOXING AND REQUIRED TOOLS

## HARDWARE KIT CONTENTS



**2x**

M8 X 30MM  
SOCKET HEAD SCREW

#003001

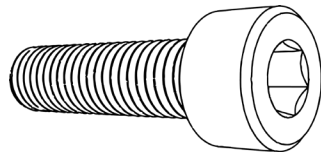

**4x**

M6 X 16MM  
SOCKET HEAD SCREW

#002993

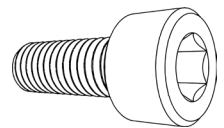

**2x**

5/16IN WASHER W/ PAD

#003029

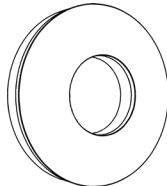

**4x**

M6 WASHER

#002993

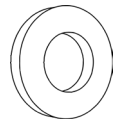

**2x**

FOAM PAD

#003693

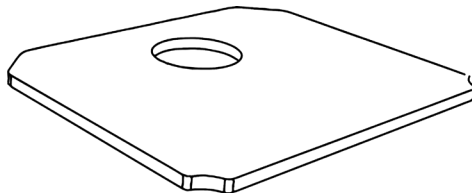

**2x**

8IN T-NUT

#003686

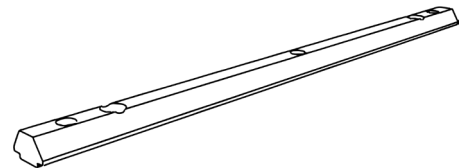

**1x**

LOCTITE

#003003



- \*Quantities are per riser pair
- \*Number of Risers depends on length of van
- \*130 Wheelbase gets 3x sets
- \*148 Wheelbase gets 4x sets

## ROOFTOP DECK - RISER KIT FOR TRANSIT VANS

Installation questions? Email [support@vancafe.com](mailto:support@vancafe.com)



## UNBOXING AND REQUIRED TOOLS

### TRANSIT RISER KIT CONTENTS

**2x**

TRANSIT RISER

#003679

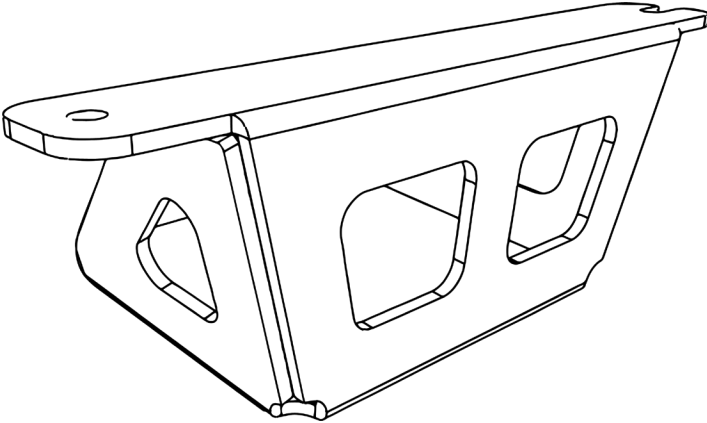

- \*Quantities are per riser pair
- \*Number of Risers depends on length of van
- \*130 Wheelbase gets 3x sets
- \*148 Wheelbase gets 4x sets

## ROOFTOP DECK - RISER KIT FOR TRANSIT VANS

Installation questions? Email [support@vancafe.com](mailto:support@vancafe.com)



## UNBOXING AND REQUIRED TOOLS

### REQUIRED TOOLS

**6MM ALLEN WRENCH**

**5MM ALLEN WRENCH**

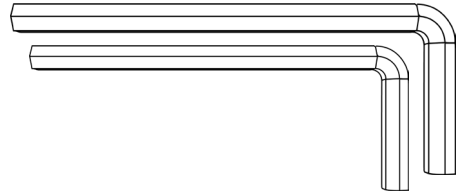

**10MM WRENCH**

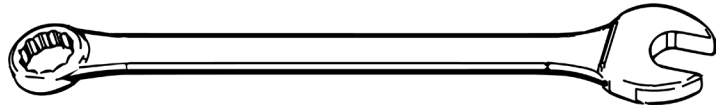

**RUBBER Mallet**

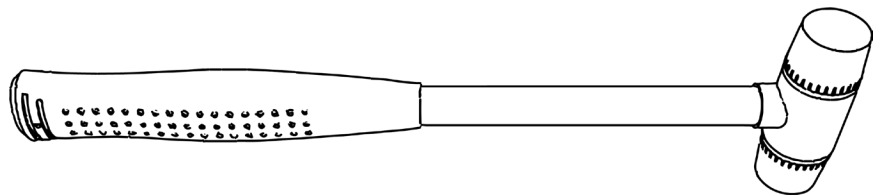

**TAPE MEASURE**

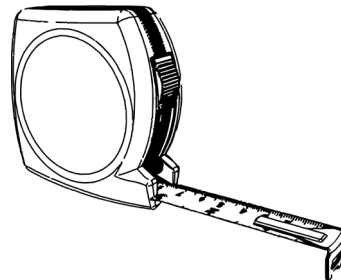

## ROOFTOP DECK - RISER KIT FOR TRANSIT VANS

Installation questions? Email [support@vancafe.com](mailto:support@vancafe.com)



# TRANSIT VAN FITMENT

THIS ROOFTOP DECK IS DESIGNED FOR  
2015-2022 FORD TRANSITS

130in Wheelbase High Roof

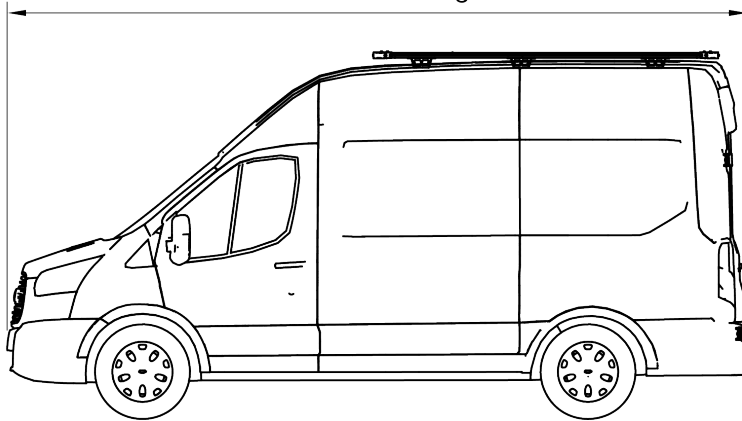

148in Wheelbase High Roof

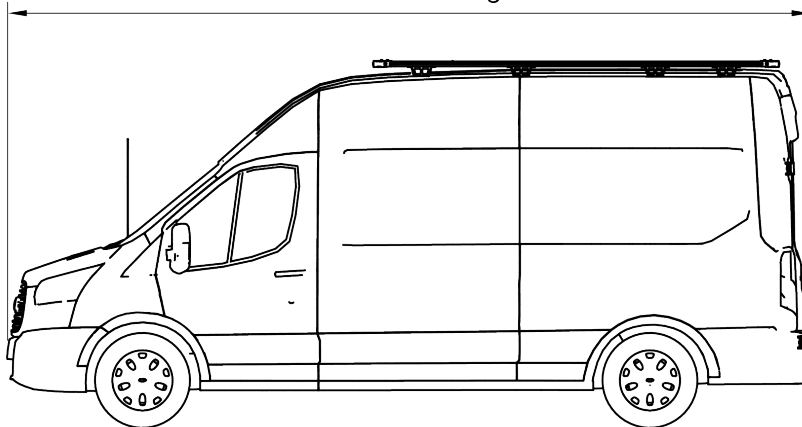

148in Wheelbase Extended High Roof

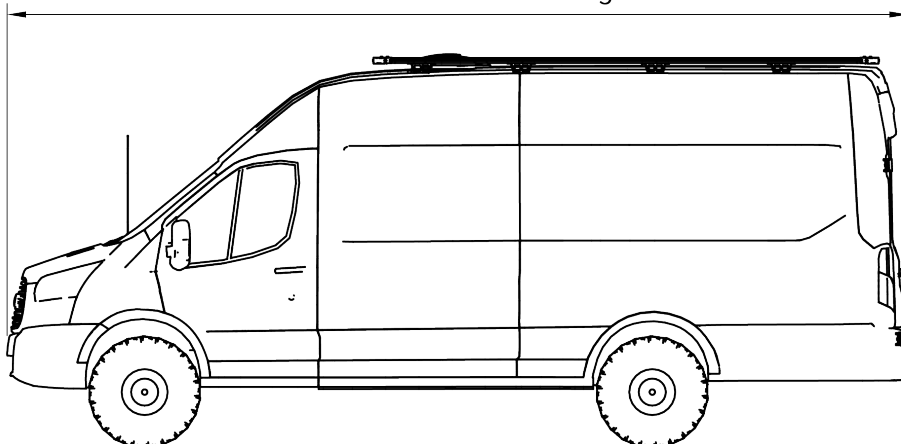

## ROOFTOP DECK - RISER KIT FOR TRANSIT VANS

Installation questions? Email [support@vancafe.com](mailto:support@vancafe.com)



## INSTALLATION STEP

1

**Remove the factory roof plugs covering the threaded inserts in your Transit roof**

**Follow the diagram to make sure you remove the correct plugs for your rack setup**

**Remove plugs circled in green**

*\*Use a razorblade to carefully cut around the perimeter of the hole plug*

*\*A little help from a heat gun makes it easier to peel them off*

*\*Extended Transit will have a set of threaded inserts not used*

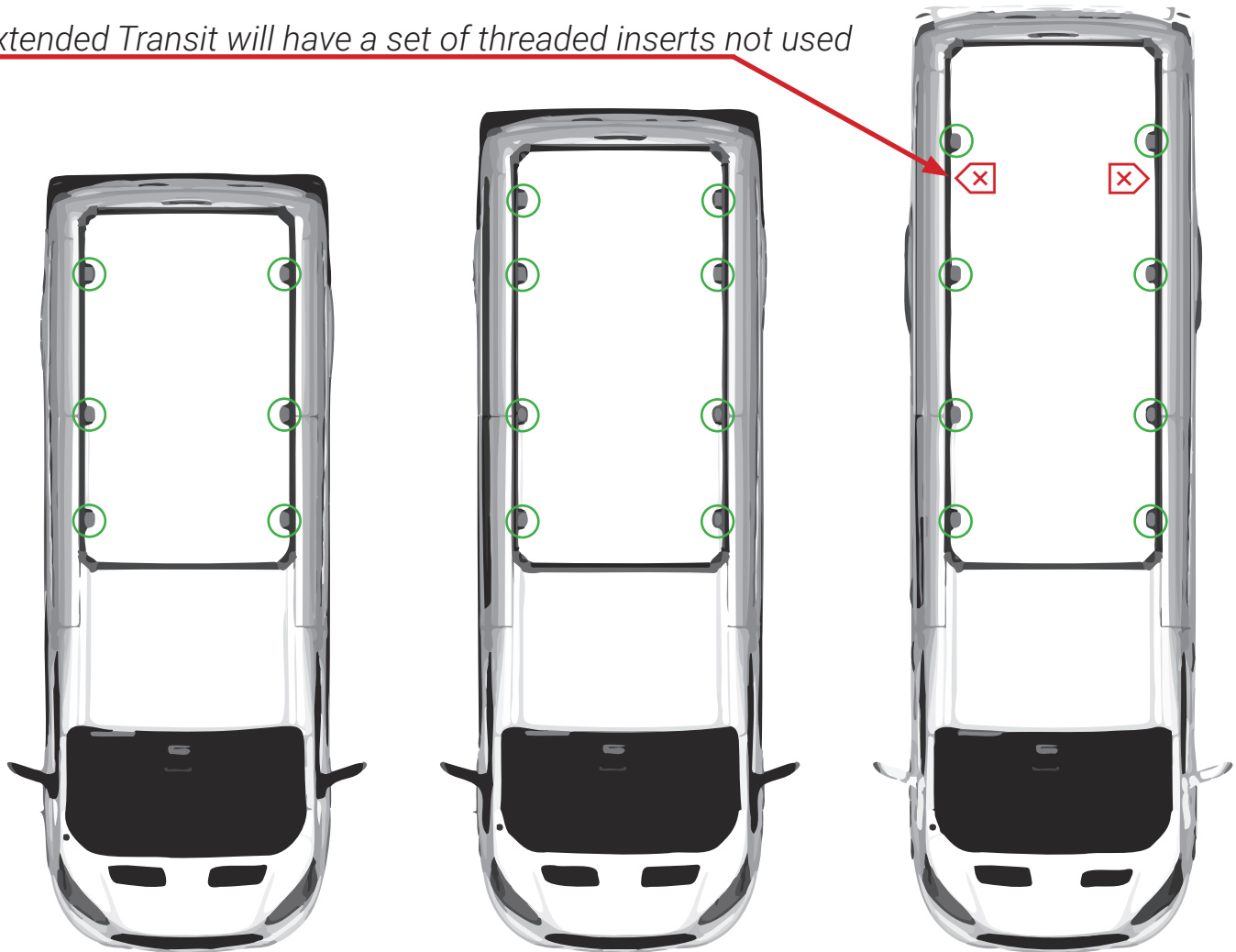

### ROOFTOP DECK - RISER KIT FOR TRANSIT VANS

Installation questions? Email [support@vancafe.com](mailto:support@vancafe.com)





## INSTALLATION STEP

1



*\*Some of the threaded inserts might be off-center from the hole in the roof and may need to be ground out with a die grinder*

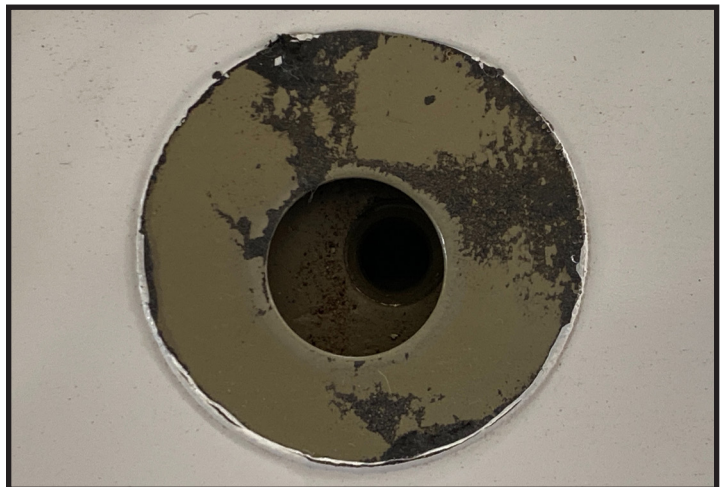

### ROOFTOP DECK - RISER KIT FOR TRANSIT VANS

Installation questions? Email [support@vancafe.com](mailto:support@vancafe.com)





## INSTALLATION STEP

2

Apply roof pads on to bottom of Transit risers

Screw washer with black pad on M8 screw

Place drop of Loctite on end of screw

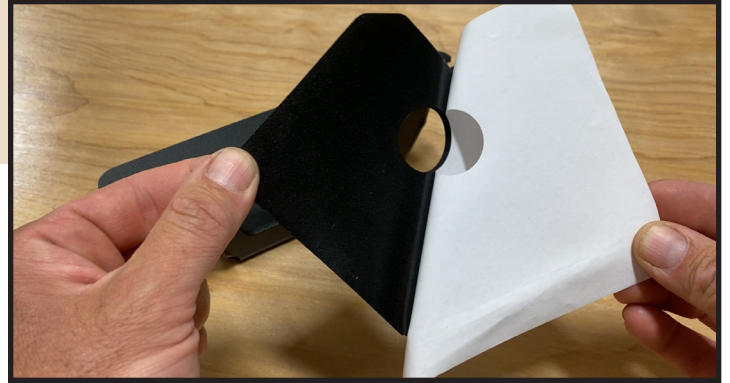
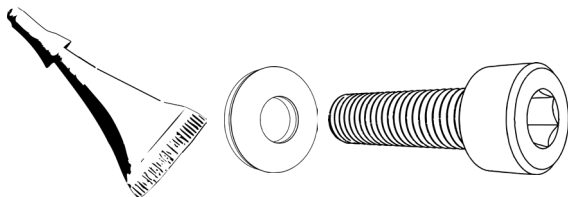
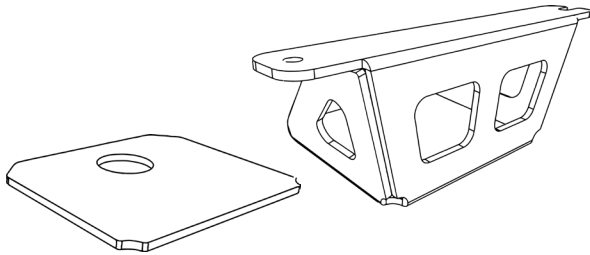
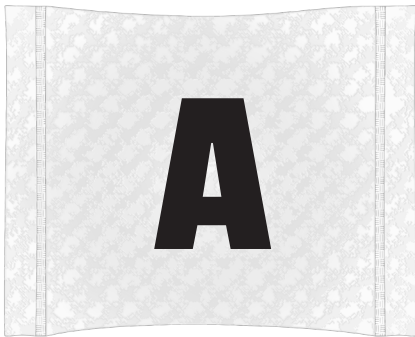

### ROOFTOP DECK - RISER KIT FOR TRANSIT VANS

Installation questions? Email [support@vancafe.com](mailto:support@vancafe.com)



## INSTALLATION STEP

3

**Position Transit riser over the hole in your roof**

**Using a 6mm allen wrench, screw M8 with Loctite into the hole**

*\*Leave loose until all extruded aluminum is installed on side rails*

*\*Because these vans aren't perfect, the holes probably won't align perfectly*

*\*The extruded aluminum perimeter track will align the risers*



### ROOFTOP DECK - RISER KIT FOR TRANSIT VANS

Installation questions? Email [support@vancafe.com](mailto:support@vancafe.com)





## INSTALLATION STEP

**4**

Put a drop of Loctite on the end of each M6 socket head screw

Thread the M6 screw in one end of the 8in T-nut

Slide it in slotted side of the riser

Screw the other M6 in through bottom of riser

*\*Leave loose until all extruded aluminum is installed on side rails*

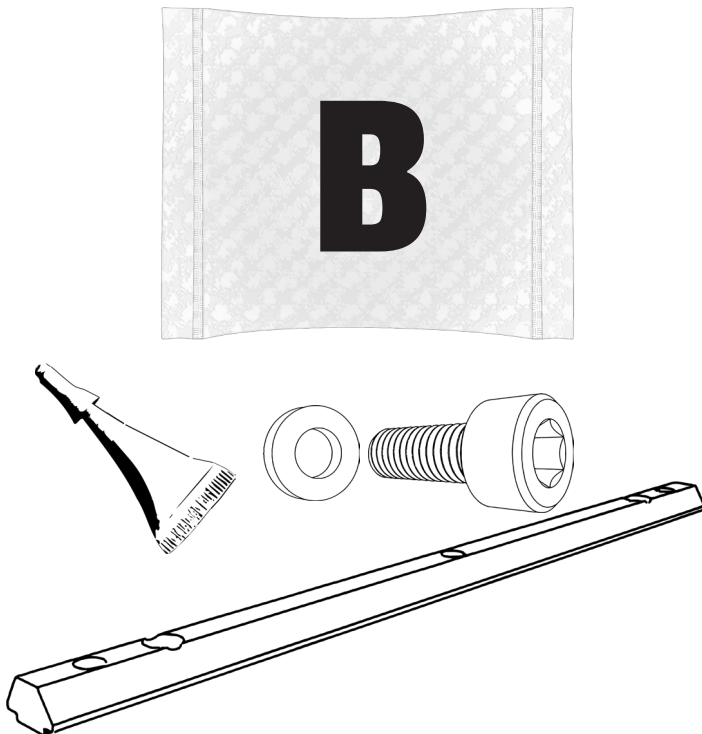
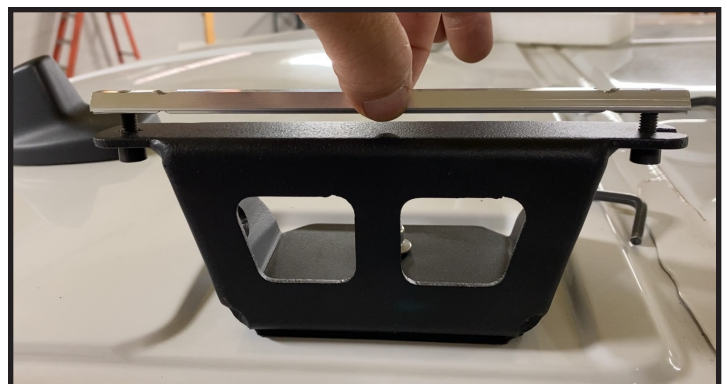

### ROOFTOP DECK - RISER KIT FOR TRANSIT VANS

Installation questions? Email [support@vancafe.com](mailto:support@vancafe.com)



## INSTALLATION STEP

5

**Continue installing the risers down both sides of the van**

*\*Leave loose until all extruded aluminum is installed on side rails*

*\*Follow the diagram on page 7*

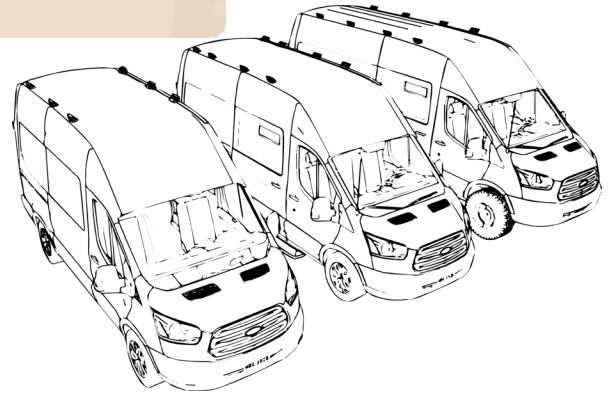

## ROOFTOP DECK - RISER KIT FOR TRANSIT VANS

Installation questions? Email [support@vancafe.com](mailto:support@vancafe.com)





# FINISHED!

That's it, you're all done!!

Now it's time to fill your Rooftop Deck up with all the cool stuff, or continue working on your own project!

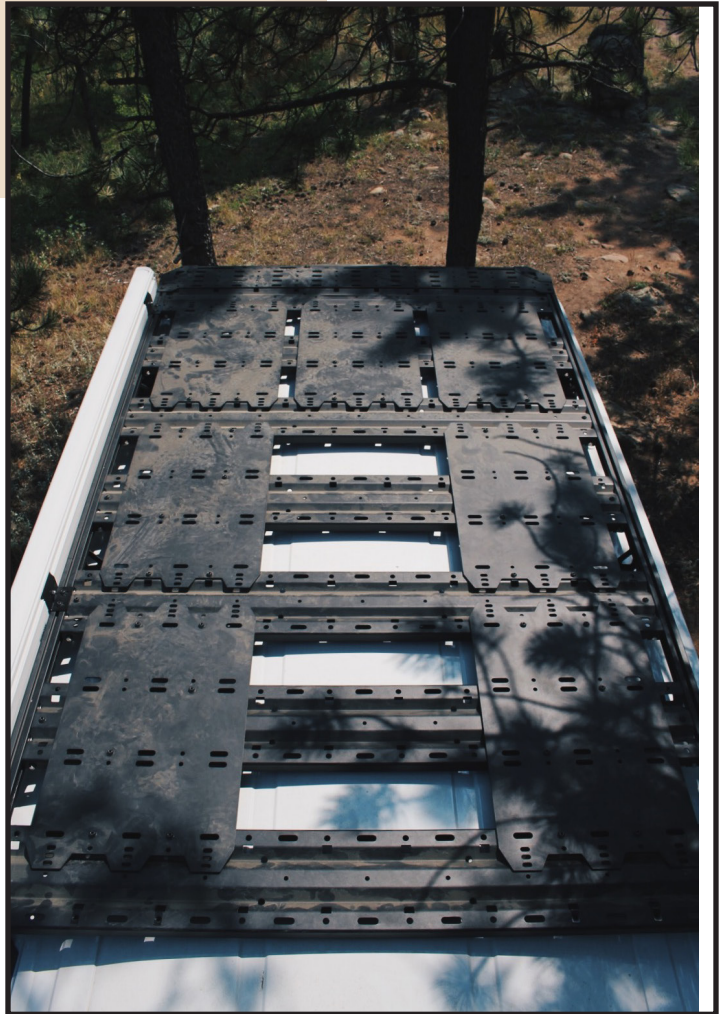

## ROOFTOP DECK - RISER KIT FOR TRANSIT VANS

Installation questions? Email [support@vancafe.com](mailto:support@vancafe.com)

